

Navigate360 Study Buddies

How to form a study group at
BU using “Study Buddies” in
Navigate360

What is Navigate360?

Navigate360 is a platform for you to connect with your BU support team and access resources to help you succeed in college.

What is Study Buddies?

Study Buddies is a tool in Navigate360 to help connect you with classmates who want to study together.



1. Get started by logging in to Navigate360.

Download the Navigate360 mobile app or visit bradley.navigate.eab.com.



2. Click on “Study Buddies”.



Mobile
Select the Study Buddies icon

Desktop
Select the Study Buddies tab

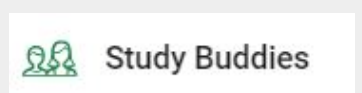

3. Find the current term and your list of enrolled courses.

Click **Join** and then select **Yes** to confirm. This will allow you to either get a group started or join an already existing group. Note: You will only see your sections.

Opt-in to receive notifications when new students join your groups via **Notification Settings** at the top.

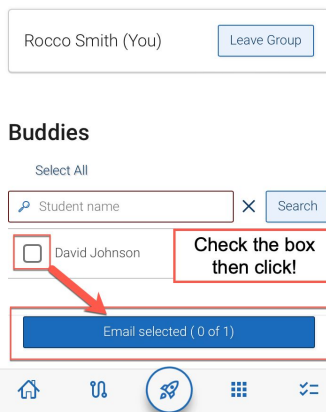
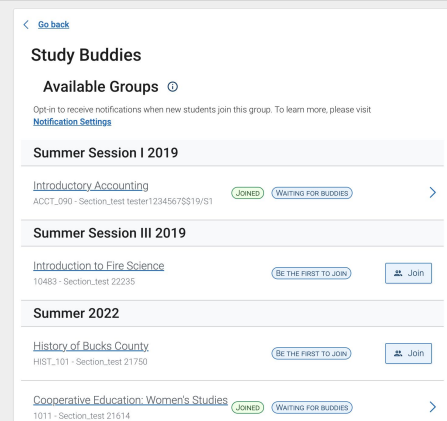

4. Select classmates.

If others in your class have opted in to Study Buddies, their name(s) will appear. You may select any/all of them and click “Email selected”.

5. Email classmates.

An automated email will pop up for you to reach out and connect. Find a time to meet and study!

